

USA OPERATIONS

Manufacturing Locations

Corrosion Resistant Equipment

Arkansas Plant	Louisiana Plant	Texas Plant
228 West Industrial Park Rd. Harrison, AR 72601 Phone: (870) 391-4792	3605 Delta Dr. St. Gabriel, LA 70776 Phone: (225) 642-8060	95 Southbelt Industrial Dr. Houston, TX 77047 Phone: (713) 433-7200

High Temperature Products

Houston-Kirbyville Plant	Houston-Ranger Plant
6833 Kirbyville St. Houston, TX 77033 Phone: (713) 644-1247	4718 Ranger St. Houston, TX 77028 Phone: (713) 671-2458

Field Service Offices

Alabama

Birmingham Office
1273 24th Avenue
Hueytown, AL 35023
Phone: (205) 426-4000

Arkansas

Harrison Office
228 West Industrial Park Road
Harrison, AR 72601
Phone: (870) 391-4792

Iowa

Camanche Office
Camanche, IA 52730
Phone: (563) 508-2622

Kentucky

Madisonville Office
Madisonville, KY 42431
Phone: (270) 635-5421

Louisiana

St. Gabriel Office
3605 Delta Drive
St. Gabriel, LA 70776
Phone: (225) 642-8060

Oklahoma

Broken Arrow Office
7838 S. Elm Place
Broken Arrow, OK 74011
Phone: (918) 455-8928

Texas

Beaumont Office
6001 Highland Avenue
Beaumont, TX 77705
Phone: (409) 838-9121

Corpus Christi Office
4602 Southview Drive
Corpus Christi, TX 78408
Phone: (361) 500-2001

Dallas Office – Industrial Flooring Services, Inc.
2736 Market Street
Garland, TX 75041
Phone: (214) 349-7891

Houston-Kirbyville Office
6833 Kirbyville Street
Houston, TX 77033
Phone: (713) 644-1247

Houston-Ranger St. Office
4718 Ranger Street
Houston, TX 77028
Phone: (713) 671-2458

Houston-Southbelt Office
95 Southbelt Industrial Drive
Houston, TX 77047
Phone: (713) 433-7200

CANADA OPERATIONS

Clayburn Services Ltd.

Alberta

Edmonton Office (Headquarters)
16010-118th Avenue
Edmonton, AB
T5V 1C6
Phone: (780) 468-4100

Calgary Office
#108 4140 – 6th Street NE
Calgary, AB
T2E 8C8
Phone: (403) 276-4421

Fort McMurray Office
306-8535 Gordon Avenue
Fort McMurray, AB
T9H 0B7
Phone: (780) 468-4100

British Columbia

Abbotsford Office
31543 King Road
Abbotsford, BC
V2T 5Z2
Phone: 1 (800) 859-4885

Prince George Office
8603 North Kelly Road
Prince George, BC
V2K 2W7
Phone: (250) 962-2322

Vancouver Island Office
1099 Popham Road
Parksville, BC
V9P 2T3
Phone: (250) 248-5353

CORPORATE HEADQUARTERS

Thorpe Specialty Services Corporation

6833 Kirbyville Street
Houston, TX 77033
Phone: (713) 644-1247
General@ThorpePME.com

OPERATING SUBSIDIARIES

Thorpe Plant Services, Inc.

J T Thorpe Company

Thorpe International Services, Inc.

Thorpe Engineered Products Company

Industrial Flooring Services, Inc.

Clayburn Services Ltd.

INTERNATIONAL

Thorpe International Services, Inc.

6833 Kirbyville Street
Houston, TX 77033
Phone: (713) 644-1247
International@ThorpePME.com

Z-BLOK™ MODULE SYSTEM



Z-BLOK™ THE STRONGEST, MOST FLEXIBLE AND MOST RELIABLE CERAMIC FIBER MODULE SYSTEM AVAILABLE

- Pre-Compressed Module.
- Large 24" x 24" Format Reduces Joints and Mounting Hardware.
- Strongest Anchoring and Attachment System.
- Custom Designed Lining Includes:
 - Furnace Analysis
 - Special Shapes
 - Accessory Engineered Products
 - Engineering Drawings
- Most Flexible Regarding Special Shapes and Sizes.
- Lowest Overall Life-Cycle Costs.



Thorpe has numerous competencies and is in the unique position to offer 3 Keys of Reliability.

- 1 Product Integrity** including a superior folded module system using the best fiber and hardware components available.
- 2 Engineering Capability** designing a complete system that addresses the furnace conditions and optimizes performance.
- 3 Installation Expertise** offering services ranging from complete turnkey packages to field assistance to meet every customer's need.

1 Pioneering design helps maintain fiber integrity while the engineered hardware maximizes stability and reliability.

THE Z-BLOK™ MODULE COMPONENTS

- REFRACTORY CERAMIC FIBER**
 - Formed from a continuous length of top quality ceramic blanket.
 - Blanket is accordion-folded, placed in compression and banded.
- LARGE FORMAT MODULE**
 - Recommended 24" x 24" module design minimizes joints and attachment points.
 - Better protects attachment hardware.
 - Helps control effects of fiber shrinkage.
 - Large format design lowers overall costs for installation and operation.

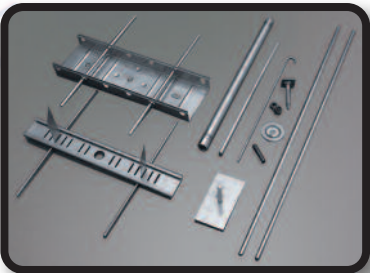

- HARDWARE**
 - Proprietary stainless steel attachment hardware is installed within 1.25" of module cold face.
 - Multiple hardware options to meet requirements of an engineered installation.
 - Proprietary installation tools to enhance construction speed and quality.

2 Module shapes and sizes are engineered to meet furnace conditions and produce a complete system that optimizes performance and reliability.

FURNACE ANALYSIS

FURNACE VARIABLES	DESIGN CONSIDERATIONS
FURNACE ENVIRONMENT	<ul style="list-style-type: none">■ Temperature (up to 3000°F)■ Velocity■ Chemical attack■ Pressure
GEOMETRY	<ul style="list-style-type: none">■ Transitions■ Bullnose■ Custom designs
PENETRATIONS	<ul style="list-style-type: none">■ Burner tiles■ Peepholes/doors■ Support castings
MOVEMENT	<ul style="list-style-type: none">■ Dynamic tube movement■ Vibrations

CUSTOM DESIGN

Based on furnace variables, size and shape — every Z-BLOK™ lining is custom designed as an engineered system to address the specific needs of the installation.

Z-BLOK™ MODULE DESIGN SPECIFICATIONS

- **SIZE VARIABLES:** Thickness x width x length.
- **MODULE DENSITIES:** Typically 8, 9, 9.3, 10.7, and 12 PCF.
- **MATERIAL TEMPERATURE RATINGS:** Standards include 2300°F and 2600°F; Special designs available up to 3000°F.

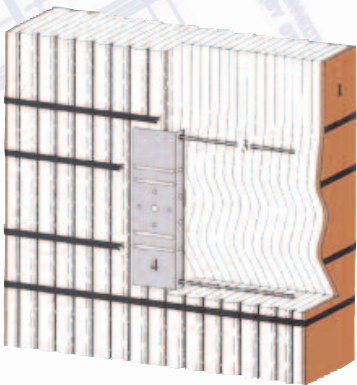

ATTACHMENT SPECIFICATIONS

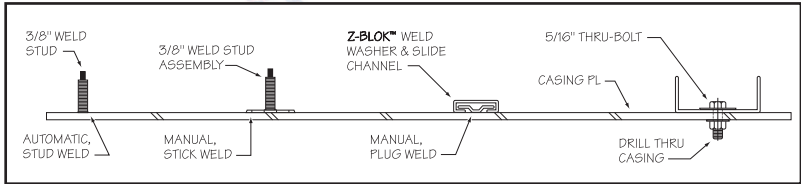

3 To ensure the customer receives a world-class lining, Thorpe competencies range from complete turnkey installations to quick turnarounds for engineered linings.

- **RESPONSIVENESS:** Thorpe will provide a turnkey, installed package or work with the end user or contractor to design the lining and meet the turnaround schedule.
- **RAPID INSTALLATION:** The large format 24" x 24" system, coupled with an engineered design using shop-fabricated modules aids installation efficiency.
- **FLEXIBILITY:** Whether the furnace requires a complete rebuild or a patch in an existing lining, the Z-BLOK™ system can be designed for the job to minimize installation time.

